

# Giant Mosquito 920 Banner Stand

## MSQT-GIANT-920-5

The Giant Mosquito retractable banner stand is an affordable banner display option that comes with unmatched versatility. The heavy duty aluminum base features a silver finish and black endcaps. A great fit for all size display areas, the Giant Mosquito has a variety of height options, all the way up to 10ft.



## features and benefits:

- Comes complete with base, snap top rail, hybrid bungee/telescopic pole and carry bag
- 10' tall maximum graphic height option
- 6' tall minimum graphic height option
- Includes carry bag or case
- Can be recycled
- 90 day hardware limited warranty against manufacturer defects

## dimensions:

Hardware	Graphic
<p>Assembled unit: 37" w x 72 - 125" h x 15.75" d 940mm(w) x 1829 - 3175mm(h) x 401mm(d)</p> <p>Approximate weight: 12 lbs / 6 kg</p>	<p>Refer to related graphic template for more information.</p> <p>One year warranty.</p> <p>Visit: <a href="http://www.exhibitors-handbook.com/graphic-templates">www.exhibitors-handbook.com/graphic-templates</a></p>
Shipping	<b>additional information:</b>
<p>1 Box(es):</p> <p>43" l x 7" h x 5" d 1093mm(l) x 178mm(h) x 127mm(d)</p> <p>Approximate total shipping weight: 13 lbs / 6 kg</p>	<p>Graphic material: Standard anti-curl vinyl, premium fabric, supreme melinex</p>

We are continually improving and modifying our product range and reserve the right to vary the specifications without prior notice. All dimensions and weights quoted are approximate and we accept no responsibility for variance. E&OE. See Graphic Templates for graphic bleed specifications.

## Giant Mosquito set-up

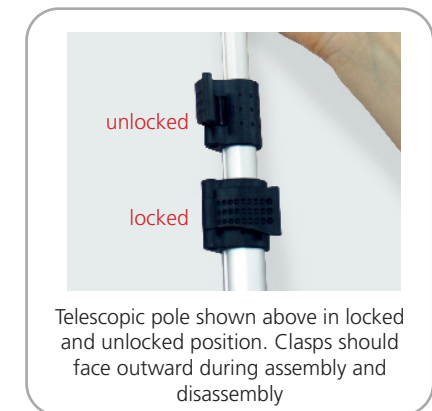
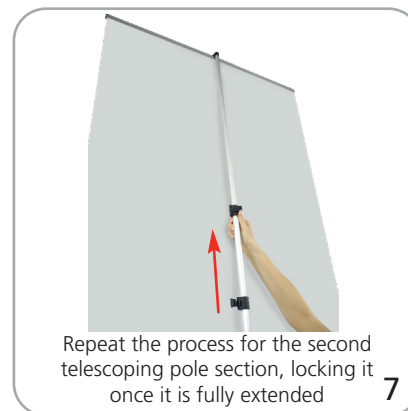
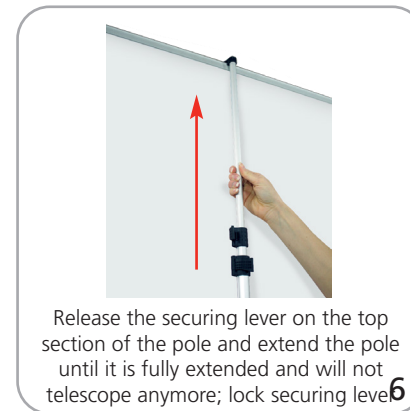
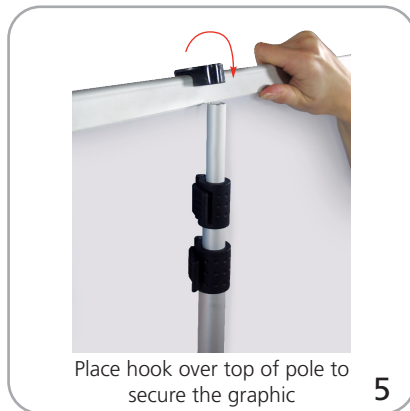
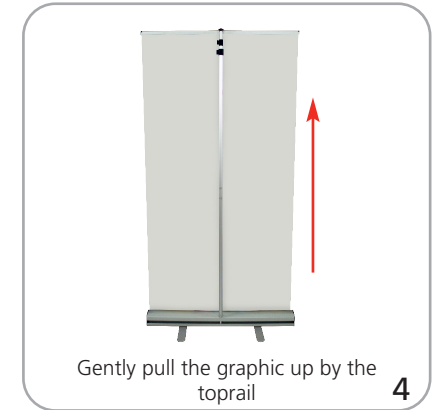
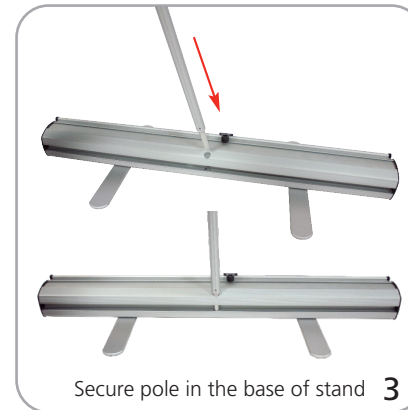

\*To disassemble from maximum height, second section of telescopic pole should be retracted first. Slowly guide the pole down towards the base and repeat with the first pole section.

## Graphic to toprail attachment

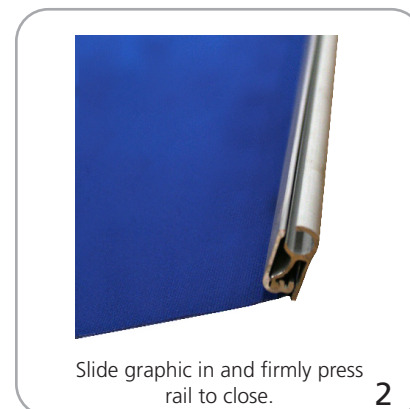

## Graphic to base attachment

