

Eurofit Twist Monitor Stand

Product Parts

- 1 - Left Shock-Cord Pole
- 2 - Back Shock-Cord Pole
- 3 - Front Shock-Cord Pole
- 4 - Right Shock-Cord Pole
- 5 - Corner Support
- 6 - Top Pole
- 7 - Top Mounting Pole
- 8 - Bottom Mounting Pole
- 9 - Top Corners (x2)
- 10 - Bottom Corner
- 11 - Bottom Supports (x2)
- 12 - Bottom-Back Shock-Cord Pole
- 13 - Bottom-Front Shock-Cord Pole
- 14 - Bottom-Right Pole

LCD Hardware

- 15 - LCD Bracket
- 16 - LCD Mounting Arms (x2)
- 17 - Tool Kit
 - Phillips Screws (x4)
 - Washers (x4)
 - Hex Wrench
- 18 - Graphic

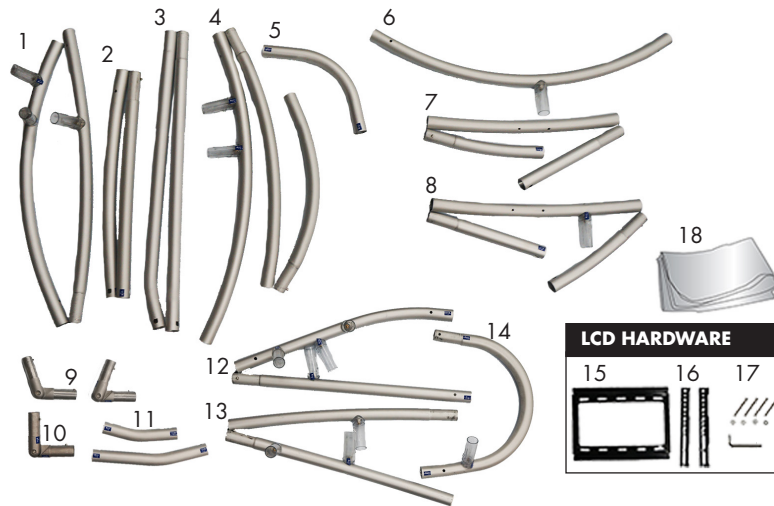

* You will need the use of a Phillips Screwdriver (Not Included)



Display Set-Up

Step 1

Remove everything from soft case and place on a clean flat surface. Verify you have all parts described above.

IMPORTANT INFORMATION

* During assembly, match the labels to each other on each connection point (Ex. T6 connects to T6).

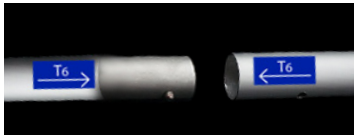

Step 3

Connect the Bottom Corner (10) on the left side of the Bottom-Front Shock-Cord Pole (13). Set Bottom assembly aside.



Step 5

Connect the Top Pole (6) and the Top & Bottom Mounting Poles (7/8) to the Left Shock-Cord Pole (1).

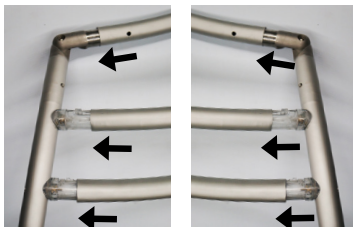

Connect the Right Shock-Cord Pole (4) to the Top Pole (6) and the Top & Bottom Mounting Poles (7/8).

Step 2

Connect the Bottom-Back and the Bottom-Front Shock-Cord Poles (12/13) together. Connect the two Bottom Supports (11) to the Bottom-Front Shock-Cord Pole. Connect the Bottom-Back Shock Cord to the two Bottom Supports. Connect the Bottom-Right Pole (14) to the Bottom-Front & Back Shock-Cord Poles (12/13).

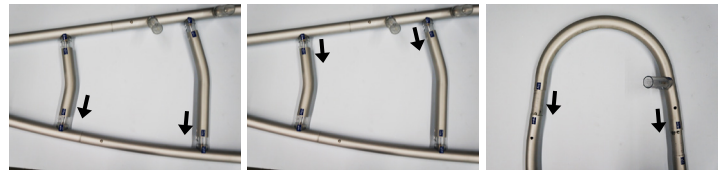

Step 4

Assemble the remaining Shock-Cord Poles. Connect the two Top Corners (9) to the tops of the Left & Right Shock-Cord Poles (1/4).

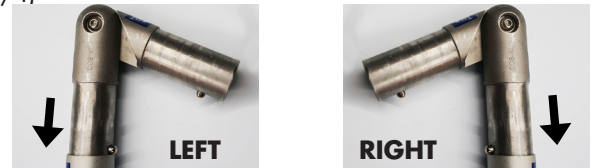

Step 6

Connect the Front Shock-Cord Pole (3) to the port hole in the middle of the Top Pole (6). Connect the Back Shock-Cord Pole (2) to the Bottom Mounting Pole. (8).

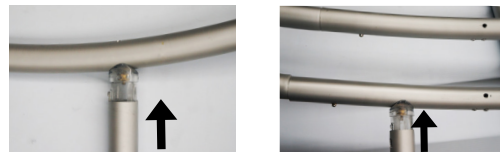

Display Set-Up Continued...

Step 7

Insert the four assembled Vertical Poles into the port holes on the Bottom Assembly.



Step 8

Tighten all screws on each of the access holes around the display with the Hex Wrench found in the Tool Kit (17).

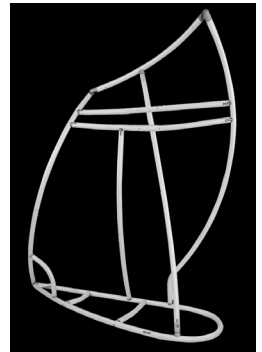

Graphic Set-Up

Step 9

With the front of the hardware facing you, slide the Graphic (18) over the top of the hardware. Continue to pull down until the top of the Graphic (18) is seated on the top of the hardware.

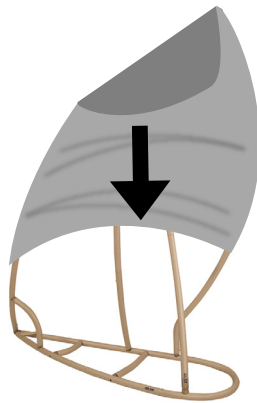

Step 10

Zip the Graphic (18) closed around the bottom of the display.



LCD Hardware Set-Up

Step 11

Using the four screws and washers from the Tool Kit (17) attach the LCD Bracket (15) to the display by lining up the holes on the LCD Bracket (15) to the holes on the Top & Bottom Mounting Poles (7/8).

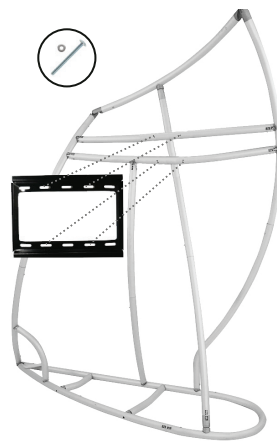

DISCLAIMER

Placing a TV that is too large or heavy for this stand could be hazardous and may cause the stand to be unstable. The TV/Monitor size limit is 32" measured diagonally, or a total weight of 25 lbs. The manufacturer is not liable for damage or injury caused by incorrect use of this television stand. Never allow children to climb or play on the stand.

Step 12

Attach the LCD Mounting Arms (16) to the back of your LCD Monitor. Screws are not included for this step as they come in different sizes based on your Brand of LCD Monitor.

Hang the LCD Mounting Arms (16) onto the LCD Bracket (15) as shown. Tighten the support screw on the back of each Mounting Arm (16).



* These Images shown are without an LCD Monitor Attached.

Storage & Care

Store in a cool dry location. Machine wash cold, gentle cycle. Air Dry Only