

Backlit Hopup

- HOP-BL2X2-C (Hardware Only Kit)
- HOP-BL3X3-C (Hardware Only Kit)
- HOP-BL4X3-C (Hardware Only Kit)
- HOP-BL2X2FGE-C (Hardware and Graphic Kit)
- HOP-BL3X3FGE-C (Hardware and Graphic Kit)
- HOP-BL4X3FGE-C (Hardware and Graphic Kit)

The state-of-the-art illuminated Backlit Hopup is simple, versatile and easily set up in minutes. Backlit Hopups create an even more dynamic Hopup display with vibrant long-lasting LED lights.



We are continually improving and modifying our product range and reserve the right to vary the specifications without prior notice. All dimensions and weights quoted are approximate and we accept no responsibility for variance. E&OE. See Graphic Templates for graphic bleed specifications.

features and benefits:

- Lighter weight anodized silver frame with a smaller footprint
- Grey in-molded Velcro end caps
- Supports an integrated full fitted fabric graphic mural with end caps
- Rear defuser graphic panel keeps hopup well illuminated (permanently applied)
- LED lights: 2x2 = 4 LED Lights, 3x3 = 9 LED lights 4x3 = 12 LED lights
- Power supply box included
- Available in 2x2, 3x3 or 4x3 sizes (curved frame only)
- Rolling carry bag included with all units
- Comes in an OCX molded case
- LED lights include one year limited warranty
- Lifetime hardware warranty against manufacturer defects
- Graphic sizes changed slightly due to new frame sizes; yet old graphics are compatible with new frame

dimensions:

Hardware	Graphic
<p>Curved Frames:</p> <p>2x2-C: 64" w x 60.5" h x 12.25" d 1626mm(w) x 1537mm(h) x 312mm(d)</p> <p>3x3-C: 92" w x 89.5" h x 12.25" d 2337mm(w) x 2274mm(h) x 312mm(d)</p> <p>4x3-C: 116.25" w x 89.5" h x 12.25" d 2953mm(w) x 2274mm(h) x 312mm(d)</p>	<p>Refer to related graphic template for more information.</p> <p>Visit: www.exhibitors-handbook.com/graphic-templates</p>

Shipping	additional information:
<p>Shipping Dimensions: OCX Case (Exterior) 39.5" l x 26.75" h x 17" d 1004mm(l) x 680mm(h) x 432mm(d)</p> <p>Approximate Shipping Weight: 2x2-C: 47 lb / 22 kg 3x3-C: 53 lb / 25 kg 4x3-C: 59 lb / 27 kg</p>	<p>Graphic materials: Backlit satin</p> <ul style="list-style-type: none"> -Always unplug the two female connectors from the power supply when raising the frame up or down -Graphic sizes changed slightly due to new frame sizes; yet old graphics are compatible with new frame -Lights & accessories are compatible from old to new design -Replacement parts available for old and new Hopup -4x3 Backlit Hopup now comes with a roller-bag packed inside the OCX case

Kit Assembly

Step by Step

Step 1.

Unpack the frame from the bag. Stand with backer side toward the floor. Stretch out the frame so it lays flat on the floor.



Step 2.

Lock the connecting arms into place. Stand the frame upright once all the connectors are securely snapped in the lock position.

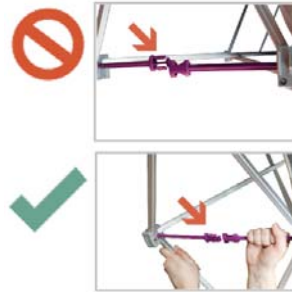

Step 3.

Apply one light per quad to the velcro on the backer panel. Make sure to align them with male/female ends accordingly for linking with the short connecting cords.



Step 4.

Vertically from top to bottom, use the small connecting cords to chain each of the lights per quad to one another.



Kit Assembly

Step by Step

Step 5.

Apply the long connector to chain the lights on the opposing vertical quads.

Please reference the Lighting Diagram for more detailed information on each frame size.



Step 6.

Plug in the lights and test the output. Be sure that all lighting is working properly. If not, check the connectivity between the lights for a snug connection between components.

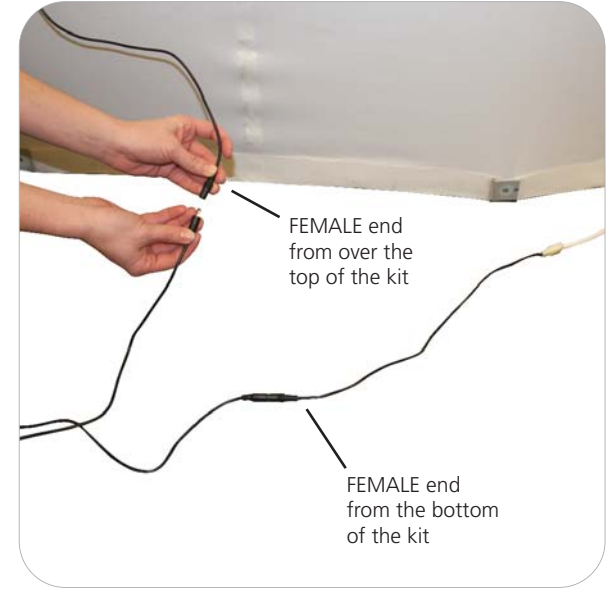

Step 7.

Once the lights are all set, it is important to disconnect the power to the lights before applying the graphic. Lay the frame back down on the floor. Apply the graphic to the frame, the endcaps do not have to be immediately applied.



Step 8.

Stand the unit back to the upright position. Power On the lights and verify that they all work. Apply the end caps by wrapping them to the back side and velcro them closed.

Setup Complete.

