

**Contents**



- Frame
- Channel Bars
- Light(s)
- Graphic/Fabric Panels
- Graphic/Fabric Case Wrap\*
- Laminated top piece\*

\*Optional

**Expanding the Frame**

Pull the frame upwards extending in all directions. Note that two orange hubs must be on the upper front corners.

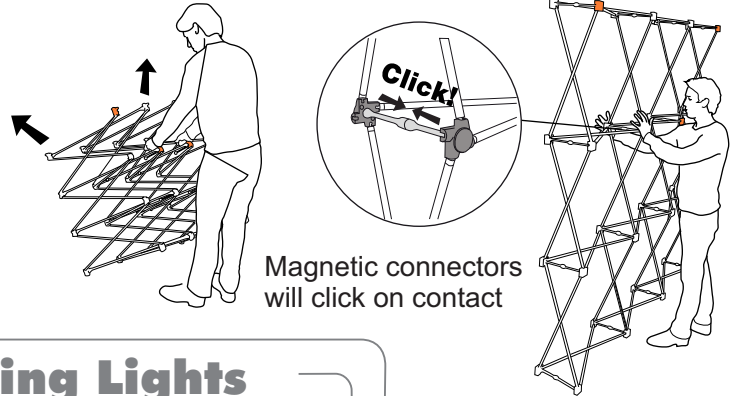

Magnetic connectors will click on contact

**STEP 1**

**Installing Lights**

Slide the lights on top of any channel bar.

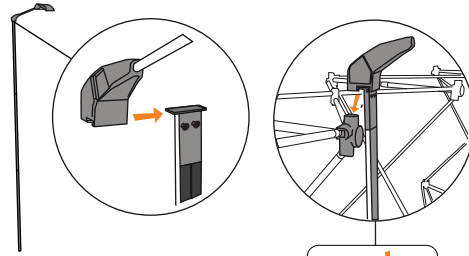

Hook the top of the channel bar to the upper hub on the frame. The magnetic hubs will snap the channel bar in place.

**STEP 3**

**Channel Bars**

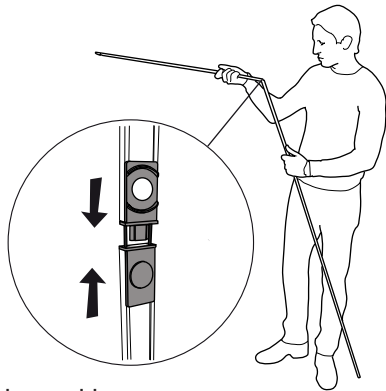
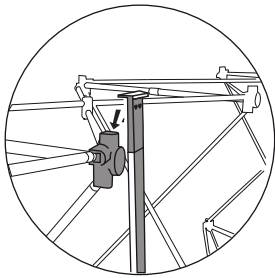

Connect the three-piece channel bars.

**STEP 2**

**Attaching Panels**

Attach panels in order, left to right or right to left. Finish with the end panels. It may be necessary to adjust panels for improved alignment.

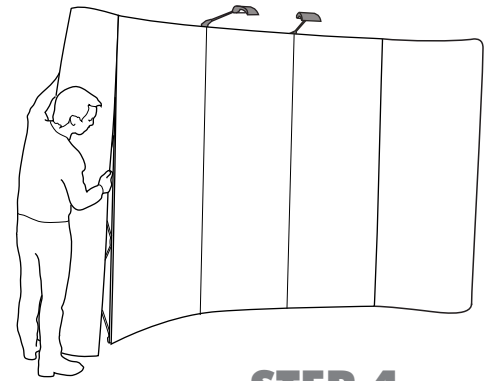
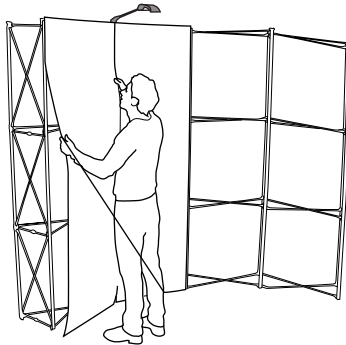

**STEP 4**

### Step 1



Connect the three microfluorescent light fixtures together, using the connector pins. Attach the power cord in the bottom.

## Bubble Panel

### Step 2

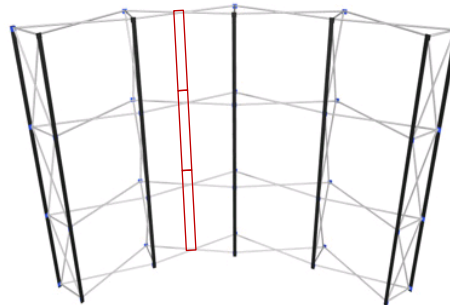

Attach the metallic hooks with velcro to the back of the light fixtures and hang on the frame.

### Step 3

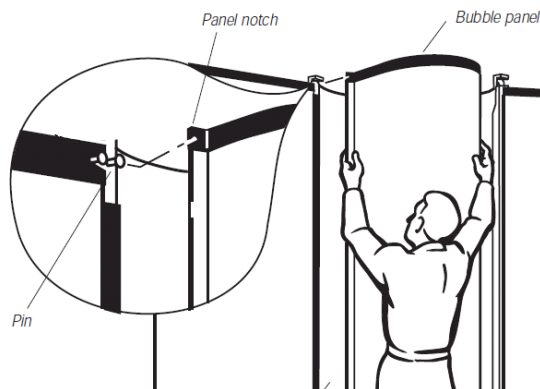

Connect Bubble Panel by hooking the panel notches over the pins at the top of the channels. Align to magnets on channels.

## End Panels

*Note: There are a variety of end panels available  
All styles attach in the same manner.*

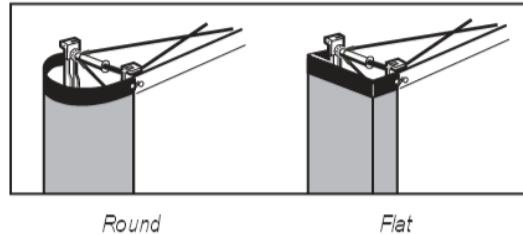

**Case to counter conversion**

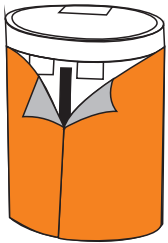

Wrap the fabric/graphic panel around the case as shown.

Place the top piece onto the top of the case



**DISMANTLING AND PACKAGING**

- 1** Remove panels starting at the bottom and carefully pulling upward, then unhook from the hubs at the top
- 2** Detach the channel bars from the frame and pack in their carry bag
- 3** Collapse the frame by gently pulling the left and right sides together
- 4** Pack the components as shown

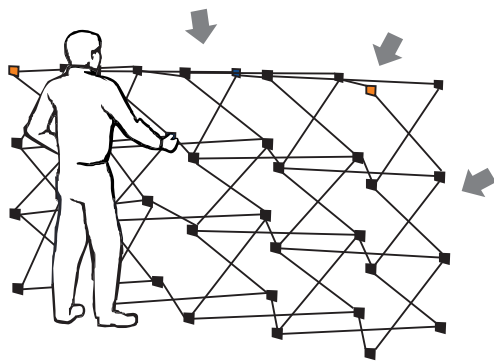
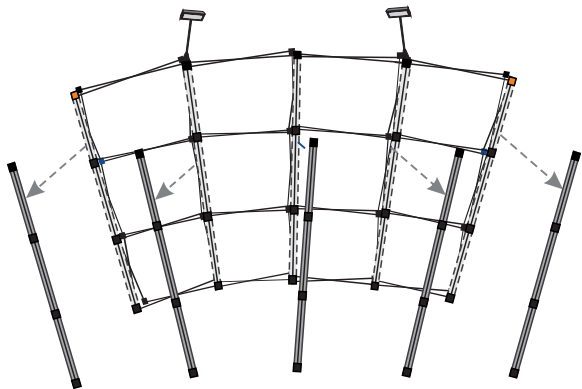

**Note:**When stored, panels must be rolled with fabric/print outside.

**LIMITED WARRANTY**

GLOBOTECH extends warranties to all its product lines to ensure customer satisfaction.

The pop up frame is backed by a limited lifetime warranty against manufacturer's physical defects in materials or workmanship under normal use by the original owner.

For other pop up components, channel bars, cases, light fixtures, accessories, the warranty period is one year.

Graphics are backed with a 90 day limited warranty on delamination or defects.

Please contact us for details at 800-682-9059.