

Power Pedestal

Product Parts

- 1 - Top
- 2 - Base
- 3 - Vertical Poles (x6)
- 4 - Charging Cables (x3)
(Lightning, Micro USB, USB Type-C)
- 5 - Power Adapter (x2)
- 6 - Graphic

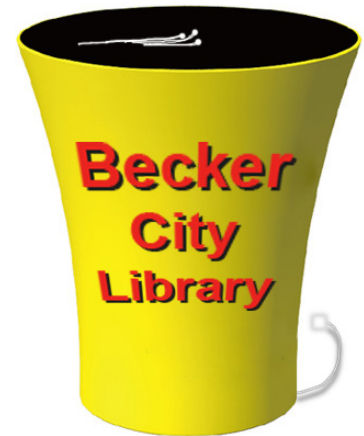
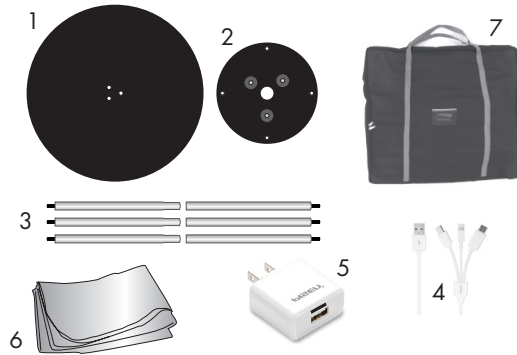

Display Set-Up

Step 1

Place on a clean, flat surface, along with your banner. Thread bolts on Vertical Poles (3) to Top and Bottom Base (1/2).



Step 2

Thread the Charging Cables (4) through the Base (2) and Top (1). Cables can go through one or 3 holes. Secure the cables together to prevent them from falling into the display with the cable hanger band attached.



Step 3

The Graphic (6) is supplied with a gasket sewn into it. Both the Top (1) and Base (2) have a groove in them for the gasket to be pushed into. The narrower end of Graphic (6) attaches to the Base (2) and can also be identified with the fabric tab. Push the Graphic (6) into the groove on the Base (2).

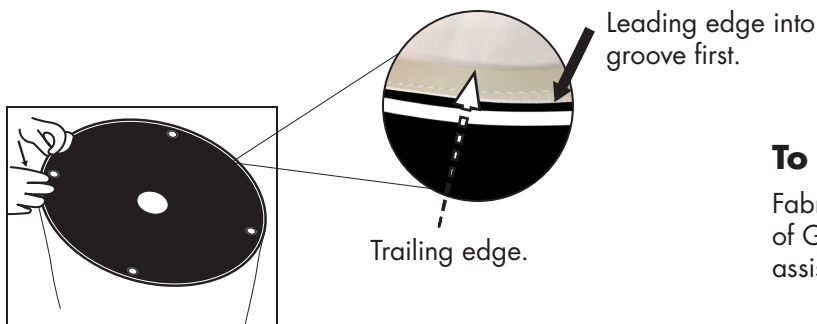

Step 4

With the Pedestal standing upright push the Graphic (6) into the groove on the Top (1).

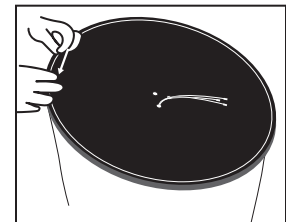

To Remove Graphic

Fabric tab is sewn onto the bottom of Graphic (6), pull this fabric tab to assist in removal of Graphic (6).

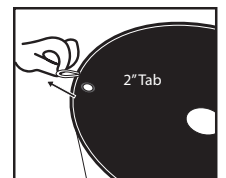

Storage & Care

Place all product parts into Carry Case (6) and store in a cool dry location. Machine wash cold, gentle cycle. Air Dry Only. DO NOT Dry Clean!